

LEGEND

- (X) PRD NO.
- PRD BOUNDARY
- MAINTAINED PORTION OF ROAD
- EMERGENCY FIRE ESCAPE ROAD (EFER)

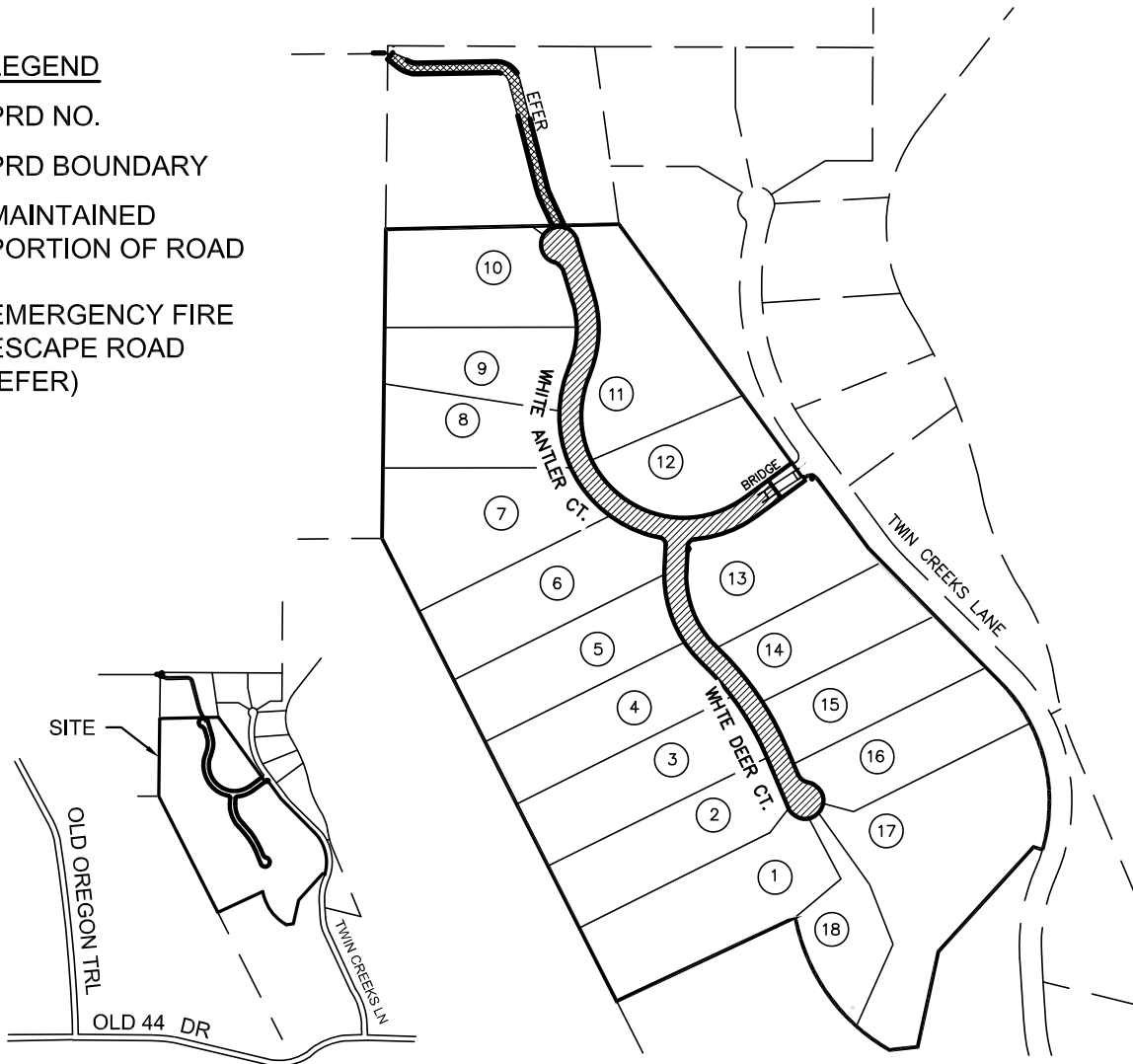

VICINITY MAP

No.	Lot No.	Property Owner
1	1	ALBERT L. SHUFELBERGER
2	2	ALBERT L. SHUFELBERGER
3	3	ALBERT L. SHUFELBERGER
4	4	ALBERT L. SHUFELBERGER
5	5	ALBERT L. SHUFELBERGER
6	6	ALBERT L. SHUFELBERGER
7	7	ALBERT L. SHUFELBERGER
8	8	ALBERT L. SHUFELBERGER
9	9	ALBERT L. SHUFELBERGER
10	10	ALBERT L. SHUFELBERGER
11	11	ALBERT L. SHUFELBERGER
12	12	ALBERT L. SHUFELBERGER
13	13	ALBERT L. SHUFELBERGER
14	14	ALBERT L. SHUFELBERGER
15	15	ALBERT L. SHUFELBERGER
16	16	ALBERT L. SHUFELBERGER
17	17	ALBERT L. SHUFELBERGER
18	18	ALBERT L. SHUFELBERGER

"COUNTY SURVEYOR'S REPORT"

PERMANENT ROAD DIVISION

STILLWATER UNIT 2 PHASE 2

IN THE W 1/2 OF SECTION 2, T31N, R4W, MDM, IN
THE UNINCORPORATED TERRITORY OF SHASTA
COUNTY, CALIFORNIA.

DATE: 06-30-23 NOT TO SCALE SHEET 1 OF 1