



PETITION FOR FORMATION OF PERMANENT ROAD DIVISION

TO: The Board of Supervisors, County of Shasta, State of California

The undersigned petitioners respectfully petition the above-entitled Board for the formation of a permanent road division pursuant to Article 3, Chapter 4, Division 2, of the Streets and Highway Code of the State of California, and respectfully show the Board:

I.

That the name of the proposed division is Stillwater Ranches Unit 2 Phase 2 Permanent Road Division.

II.

That the signatures hereunto affixed are the signatures of at least 60% of the landowners and at least 50% of the total assessed valuation within the hereinafter described boundaries of the proposed division.

III.

That the boundaries of the proposed division are as described in Exhibit "A" attached hereto and incorporated herein.

IV.

That the number of acres within the boundaries of the proposed division is approximately 54.10 acres.

V.

That the assessed valuation of the said acreage within the boundaries of the said proposed division according to the last equalized assessment roll of the County of Shasta, State of California, is as follows: \$0.00.

VI.

That the value of the improvements on real estate and of the personal property within the proposed division according to the last equalized assessment roll is as follows: \$ 1,908,676.00.

VII.

That the total assessed value of acreage and improvements within the proposed division according to the last equalized assessment roll is as follows: \$ 1,908,676.00.

VIII.

That the number of the dwellings within the boundaries of said proposed division, as nearly as can be ascertained, is as follows: 0.

IX.

That the location of the roadways and facilities which are desired to be permanently maintained is shown on Exhibit "A" as the following named roads: White Antler Court, White Deer Court, White Antler Court at Stillwater Creek bridge, and Stillwater Ranches Emergency Fire Escape Road (EFER).

Page 2

Date _____

Shute/barger *Shute/barger*

9565 Twin Creek Rd 8-11-2023

[illegible]

LEGEND



PRD NO.



PRD BOUNDARY



MAINTAINED
PORTION OF ROAD



EMERGENCY FIRE
ESCAPE ROAD
(EFER)

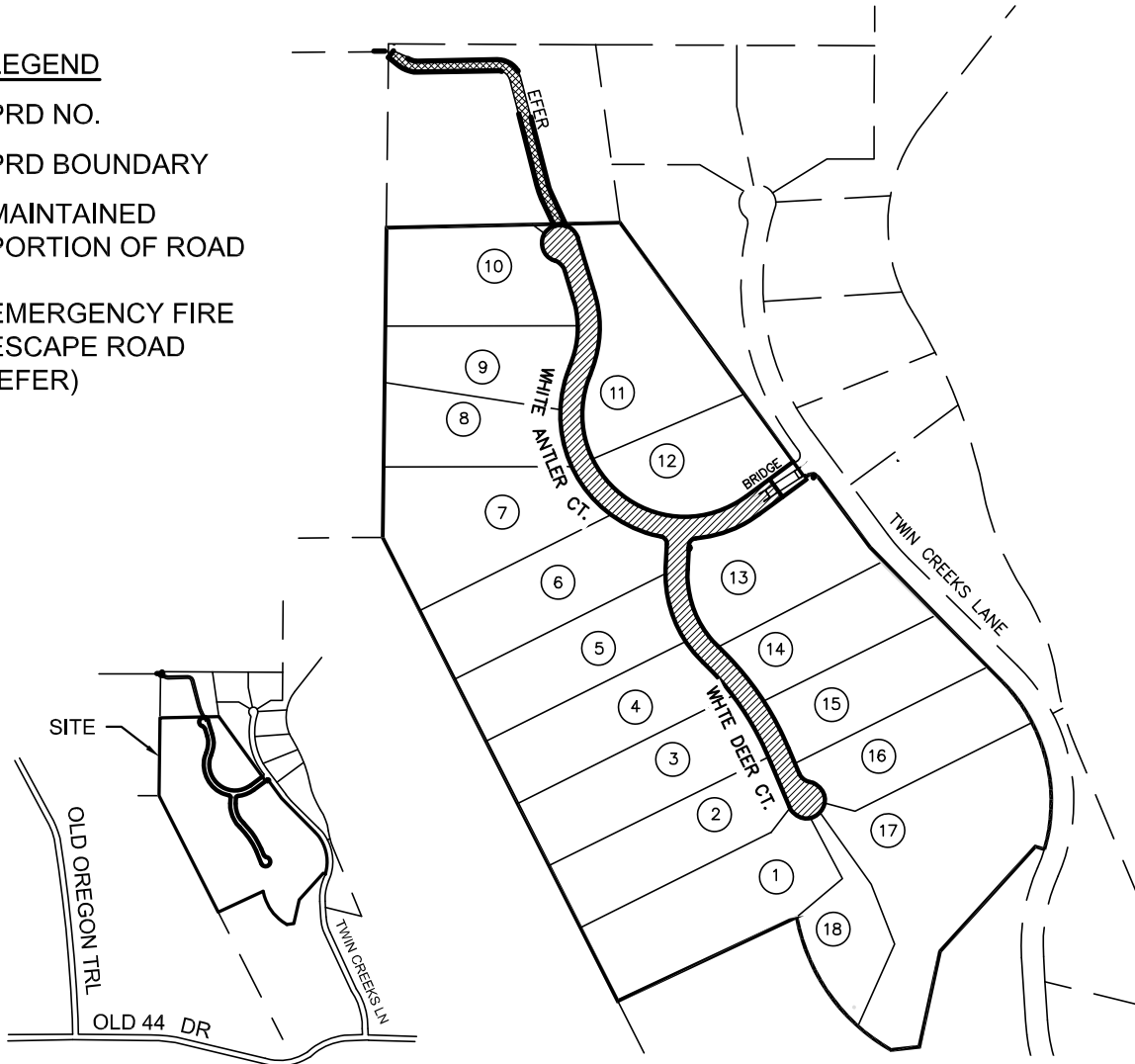

VICINITY MAP

No.	Lot No.	Property Owner
1	1	ALBERT L. SHUFELBERGER
2	2	ALBERT L. SHUFELBERGER
3	3	ALBERT L. SHUFELBERGER
4	4	ALBERT L. SHUFELBERGER
5	5	ALBERT L. SHUFELBERGER
6	6	ALBERT L. SHUFELBERGER
7	7	ALBERT L. SHUFELBERGER
8	8	ALBERT L. SHUFELBERGER
9	9	ALBERT L. SHUFELBERGER
10	10	ALBERT L. SHUFELBERGER
11	11	ALBERT L. SHUFELBERGER
12	12	ALBERT L. SHUFELBERGER
13	13	ALBERT L. SHUFELBERGER
14	14	ALBERT L. SHUFELBERGER
15	15	ALBERT L. SHUFELBERGER
16	16	ALBERT L. SHUFELBERGER
17	17	ALBERT L. SHUFELBERGER
18	18	ALBERT L. SHUFELBERGER

"EXHIBIT A"

PERMANENT ROAD DIVISION

STILLWATER UNIT 2 PHASE 2

IN THE W 1/2 OF SECTION 2, T31N, R4W, MDM, IN
THE UNINCORPORATED TERRITORY OF SHASTA
COUNTY, CALIFORNIA.

DATE: 06-30-23 NOT TO SCALE SHEET 1 OF 1